

EXTREMI**LOCK**TM

Ankle Plating System

DISTAL FIBULA PLATES

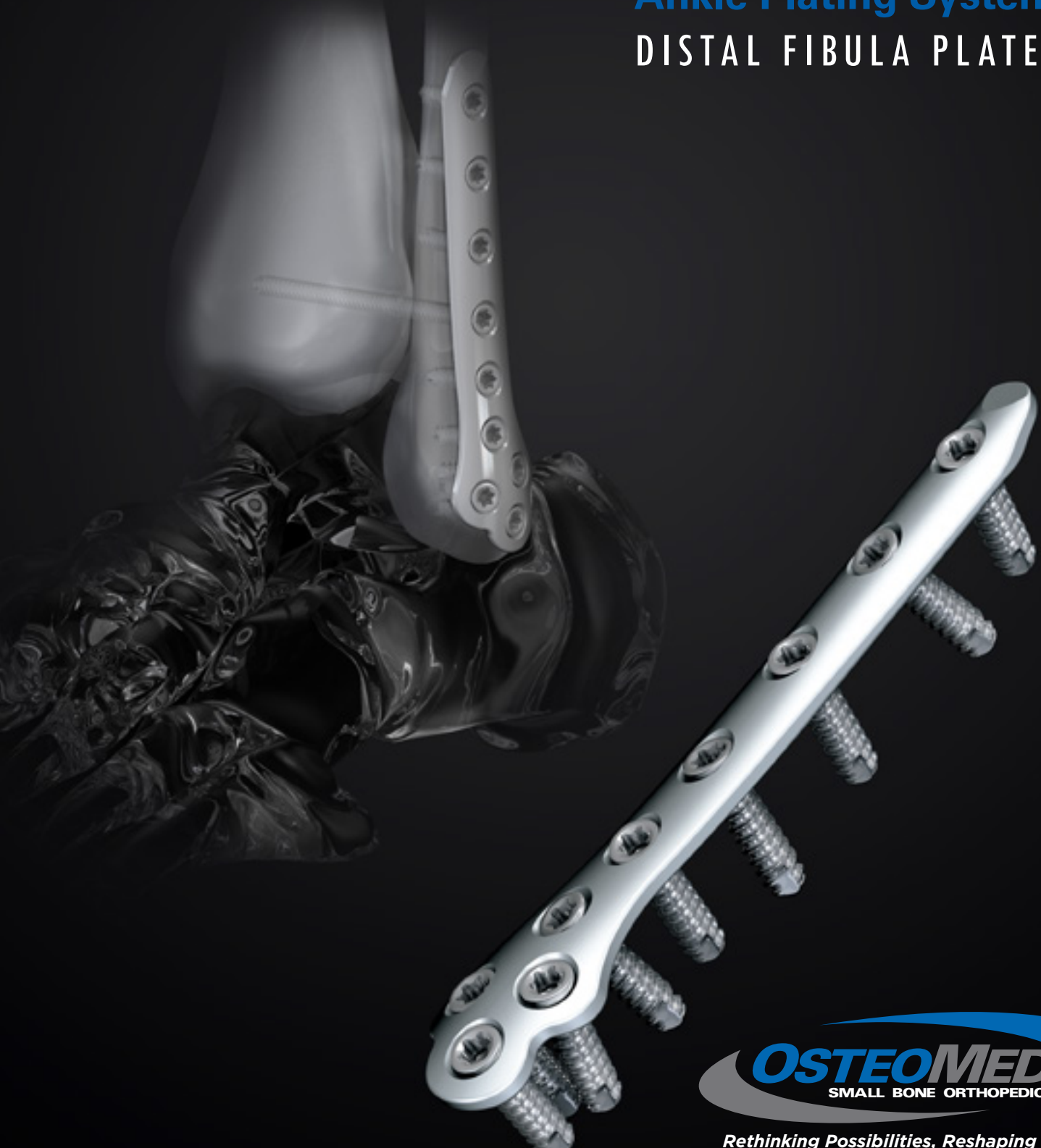

Rethinking Possibilities, Reshaping Lives

PRODUCT DESCRIPTION

The OsteoMed ExtremiLock Ankle Distal Fibula plates are designed to treat fractures of the distal fibula. The low profile plates are contoured to closely match the average anatomical shape of the fibula's lateral malleolus requiring minimal intraoperative plate contouring and providing multiple points of fixation to treat comminuted fractures.

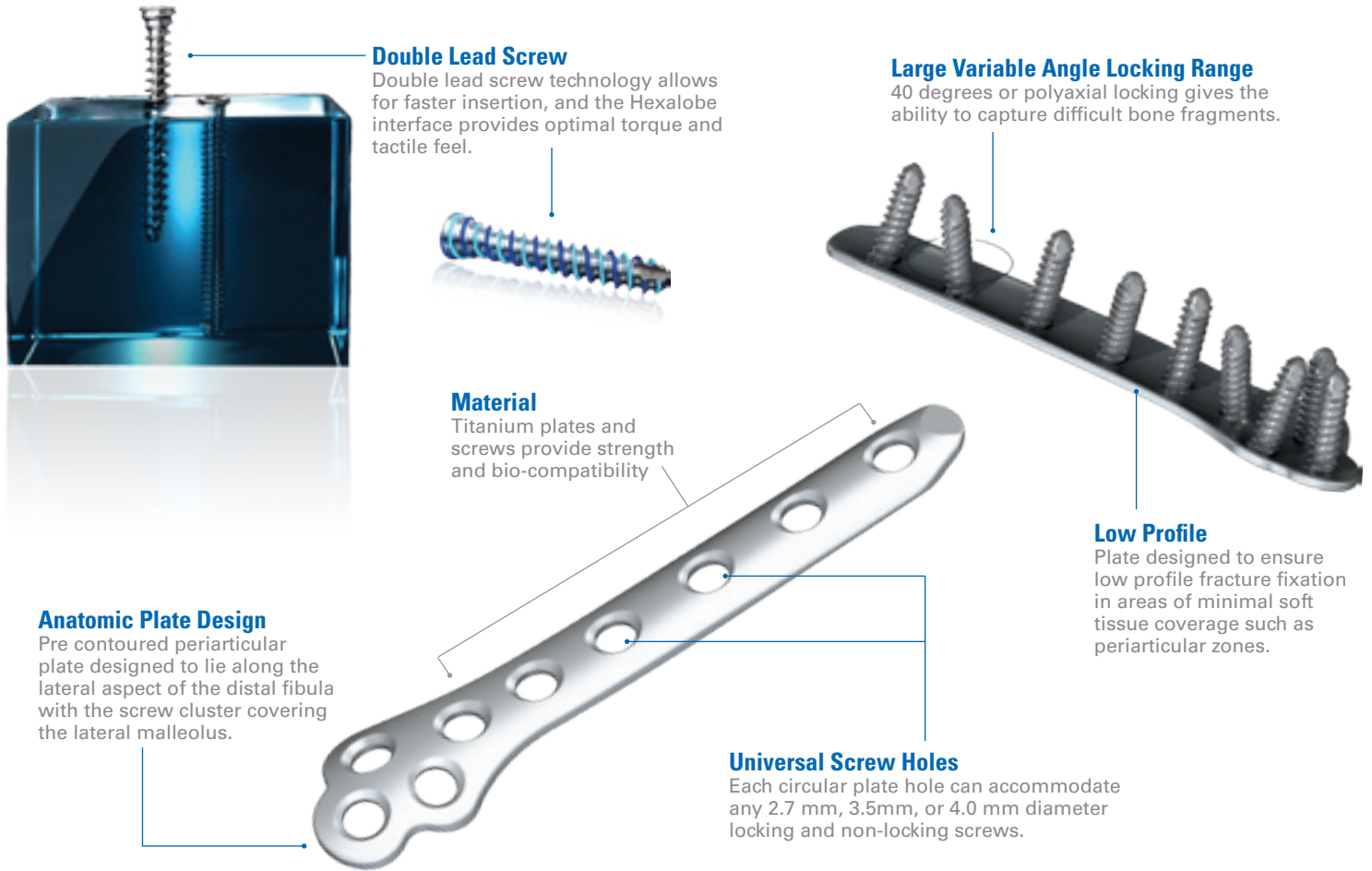

Double Lead Screw
Double lead screw technology allows for faster insertion, and the Hexalobe interface provides optimal torque and tactile feel.

Large Variable Angle Locking Range
40 degrees or polyaxial locking gives the ability to capture difficult bone fragments.

Material
Titanium plates and screws provide strength and bio-compatibility

Low Profile
Plate designed to ensure low profile fracture fixation in areas of minimal soft tissue coverage such as periarticular zones.

Anatomic Plate Design
Pre contoured periarticular plate designed to lie along the lateral aspect of the distal fibula with the screw cluster covering the lateral malleolus.

Universal Screw Holes
Each circular plate hole can accommodate any 2.7 mm, 3.5mm, or 4.0 mm diameter locking and non-locking screws.

PRODUCT OFFERING

336-6102	2H Distal Fibula Plate, Left	336-6202	2H Distal Fibula Plate, Right
336-6103	3H Distal Fibula Plate, Left	336-6203	3H Distal Fibula Plate, Right
336-6104	4H Distal Fibula Plate, Left	336-6204	4H Distal Fibula Plate, Right
336-6105	5H Distal Fibula Plate, Left	336-6205	5H Distal Fibula Plate, Right
336-6106	6H Distal Fibula Plate, Left	336-6206	6H Distal Fibula Plate, Right
336-6107	7H Distal Fibula Plate, Left	336-6207	7H Distal Fibula Plate, Right
336-6108	8H Distal Fibula Plate, Left	336-6208	8H Distal Fibula Plate, Right
336-6109	9H Distal Fibula Plate, Left	336-6209	9H Distal Fibula Plate, Right
336-6110	10H Distal Fibula Plate, Left	336-6210	10H Distal Fibula Plate, Right
336-6111	11H Distal Fibula Plate, Left	336-6211	11H Distal Fibula Plate, Right
336-6112	12H Distal Fibula Plate, Left	336-6212	12H Distal Fibula Plate, Right
336-6113	13H Distal Fibula Plate, Left	336-6213	13H Distal Fibula Plate, Right
336-6114	14H Distal Fibula Plate, Left	336-6214	14H Distal Fibula Plate, Right